



**RT33**



## **Instruction Manual**

---

**Manuel d'utilisation / Gebrauchsanweisung  
Manuale d'istruzioni Indice / Manual de instrucciones  
Handleiding / Bruksanvisning  
Instrukcja obsługi / Instruktionsmanual  
Εγχειρίδιο χρήσης / Manual de instruções  
Käyttöopas / 日本語**

***RT33***

**Instruction Manual**

** BEFORE USE**

---

---

**PRIOR TO USE, READ THIS INSTRUCTION  
MANUAL THOROUGHLY AND KEEP THIS  
FOR FUTURE REFERENCE**

---

---

RT33 Instruction Manual / Table of Contents.....P-1

Helmet Description.....P-2

## **For Safe and Comfortable Use**

**Notes Before Use** ..... P-3

## **Chinstraps**

**1** Remove/Replace Chinstrap covers ..... P-5

**2** Fastening Chinstraps ..... P-6

## **Air-Conditioning Function of Ventilations**

**3** Open/Close Chin Ventilation ..... P-6

**4** "Ventilation System" and "Wake Stabilizer <sup>PATENTED</sup>" ..... P-7

**5** Open/Close Head Ventilation and Rear Ventilation ..... P-8

## **Shield**

**6** Single Action Shield System <sup>PATENTED</sup> ..... P-9

**7** Remove/Replace of Shield Ratchets ..... P-11

**8** Shield Post-3 ..... P-13

**9** Pinlock® Original Insert Lens ..... P-14

**10** Replace Shield-3 (Optional Parts) ..... P-17

### **IMPORTANT**

To Avoid Pinlock® Pin from Turning Together With Shield Post-3 ..... P-18

## **Interior (Inner Pad and Cheek Pads)**

**11** Remove/Replace Cheek Pads ..... P-19

**12** Remove/Replace Inner Pad ..... P-20

[NOTE] Exchangeable Inner Pad, Cheek Pads and Chinstrap covers ..... P-21

### **IMPORTANT**

Cleaning of Inner Pad, Cheek Pads and Chinstrap covers ..... P-21

## **Wind Shutter / Breath Guard**

**13** Remove/Replace Wind Shutter-2 ..... P-22

**14** Remove/Replace Breath Guard-5 ..... P-23

## **Inquiries / Parts List**

Contact for inquiries and request for repair ..... P-24

• RT-33 Parts List and Table for Replacement ..... P-25

# RT33 Helmet Description



## NOTES BEFORE USE

Thank you very much for purchasing a Kabuto helmet.

This Instruction Manual describes proper handling, various functions and remove/replace each part of this helmet. Please read this Instruction Manual thoroughly prior to use. After reading this, keep the Manual for future reference. The helmet is just one element of protection, it is intended to minimize the risk in the event of an accident. It cannot ensure complete safety. Use this helmet properly based on this understanding.

Please understand and follow the instructions and information in this Instruction Manual to enjoy your safe ride.

### **Select the proper size!**

It is very dangerous to wear too large sized helmet. This may wobble while riding. If you wear a too small size helmet, it tightens up and hurts your head. Thus, it is important to select the proper size.

### **Fasten the chinstraps before riding**

The helmet is designed to be retained by straps under the chin. In order to assure proper protection, the helmet should fit your head. When worn, adjust it to rest properly on the head, securely fasten the chinstraps to ensure safety. The chinstraps prevent the helmet from coming off in most cases.

### **Never use the helmet once impacted**

Liners are essential for the intended performance of the helmet. This helmet has been designed to absorb the impact energy when components as shell and liners are partially destroyed by an impact. Even if visually no damage is apparent, it could be seriously damaged by a small impact. Regardless of the degree of damage, the helmet that underwent an impact or was abused even only once should not be used anymore. Always handle the helmet with care and make sure that no one sits on it or drops it.

### **Never modify the helmet**

In order to fully maintain the performance of this helmet, do not attempt to take apart or change the helmet in any manner such as making holes in it, cutting it, scraping off the protective liner, or modifying the straps.

### **Helmet care and cleaning**

Clean the helmet with soft cloth, using common ph-neutral detergent diluted with clear water. The cloth should not be soaking wet. Then wipe the helmet gently with a clean wet soft cloth and leave it to dry completely, but not in direct sunlight. With regard to helmets with removable interiors, carefully read the instruction manual for that model before attempting to remove the interiors and carry out cleaning according to the explanation provided. To clean the helmet, do not use saline water or hot water (above 50°C).

## **Do not paint or apply solvent**

Any paint, glue, adhesive stickers, etc. (or the use of detergents and solvents other than those prescribed) may not only reduce the original protective performance of the helmet considerably, but may also cause damage to the helmet that cannot be detected by the naked eye.

## **Handle your helmet with care**

Do not toss your helmet over a floor or sit on it. The helmet absorbs an impact every time it is handled roughly and its impact-absorbing capacity will be decreased. Handle your helmet with care to assure its full intended function in the event of an accident. Do not use your helmet for any purpose other than to use for protecting your head while riding.

## **The storage of the helmet**

After using the helmet, stow it away in the helmet bag and store on a level place such as a shelf; the helmet may be damaged if it rolls around or falls down. Do not leave the helmet in direct heat above 50°C e.g. next to a heater or under direct sunlight in a car.

## **Shield care and cleaning**

After using your helmet, with a wet soft cloth, lightly wipe off any grime (e.g. dead insects, dirt, sand, dust, etc.) on the shield and then fully wipe it clean using a dry soft cloth. When the shield gets wet (e.g. rainwater), it should always be wiped with a soft cloth after use. When cleaning the shield, never use any petroleum-based solvents or detergents containing abrasives. Contact with petroleum products and other solvents may impair the optical properties and reduce the mechanical strength. To clean the shield, apply some common ph-neutral detergent diluted with clear water using a soft cloth and wipe gently. Finally, wipe it dry with a lint-free soft cloth. To clean the shield, do not use saline water or hot water (above 50°C).

## **Cautions for shield**

If the visor is marked "Day Time Use Only", visibility is limited to daylight conditions and it is not suitable for use at night. Tinted lenses are not suitable for use at night. A visor and goggles with scratches lowers the visibility and this is very dangerous. Such visors should never be used at night and should be replaced. Contact with petroleum products and other solvents may impair the optical properties and weaken the strength of the visor. Never try to open and close nor remove the visor while riding.

## **Notes for use of full-face helmet**

When you wear a full-face helmet, the temperature in the helmet is maintained nearly constant during riding but the surroundings are constantly changing since you are moving at a high speed. For this reason, in case of sudden rain, immediately after entering a tunnel or in a place with a large height difference, the shield can be fogged suddenly because of the difference in temperature in-and-outside the helmet. In case such a risk is expected, please use caution with adjusting the shield or slowing down your speed in advance.

Never open and close the shield nor adjust the ventilation shutter while riding since it is very dangerous. Adjust the shield before riding.

# 1 Fastening Chinstraps

When the chinstrap covers of RT-33 helmet become dirty, they may be washed after detaching them from the chinstraps.

## -DETACHING-

1. Undo the snap at the end of each chinstrap.
2. Pull the chinstrap cover from the chinstrap to detach it.

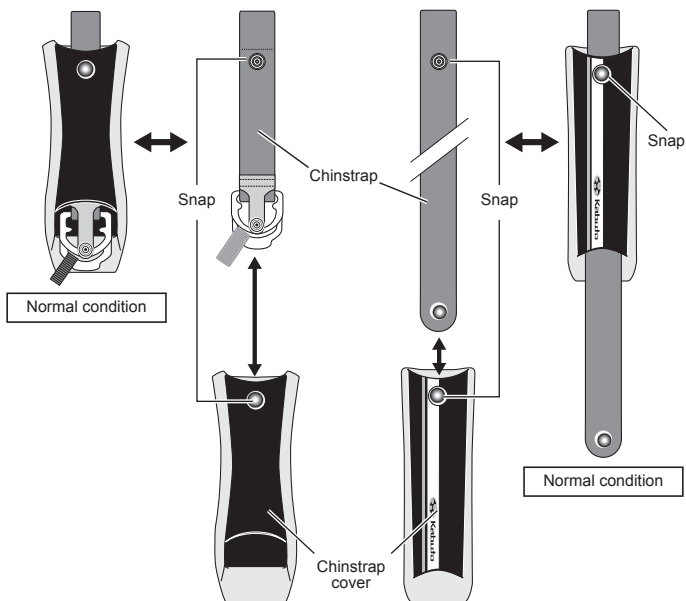

## -ATTACHING-

1. In the reverse order of detaching (pay attention to the direction of the chinstrap cover), let the chinstrap go through from the upper portion of the chinstrap cover.
2. Finally, fasten the snap.

## ! CAUTION!

- When washing the chinstrap covers, put them into a washing net or a similar item to prevent fibres from being damaged by a washing machine.
- If fastening the chinstrap cover in the reverse direction, the D ring will be hidden, therefore, pay attention to its direction when attaching it.

## 2 Fastening Chinstraps

1. Let the strap go through the D-ring, and pull the strap to the direction of the arrow to fasten it.
2. Fasten the snaps to prevent looseness in the chinstrap.

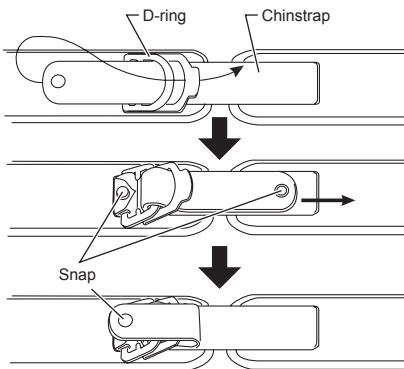

### **WARNING!**

Be sure to fasten the chinstrap securely. Otherwise, in case of falling down or an accident while riding, the helmet may drop off, and may cause serious injuries.

## 3 Open/Close of Chin Ventilation

### To open

Slide the shutter downwards to take in air.



Chin Ventilation

### To close

Slide the shutter upwards to shut off air intake.

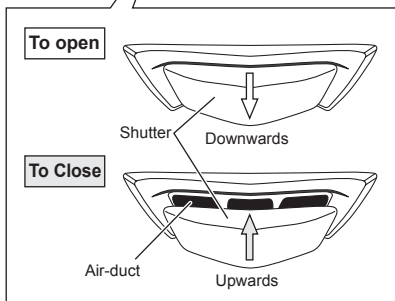

### **WARNING!**

Never operate the shutter while riding because it is very dangerous. Operate the shutter before riding.



## 4 “Ventilation System” and “Wake Stabilizer”<sup>PATENTED</sup>

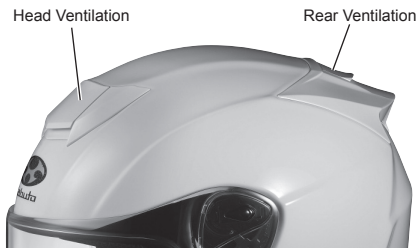

### Ventilation System:

The ventilation system effectively takes outer air in and pushes the inner humid air out by the air pressure from the front while riding. The ventilations are equipped with a shutter which prevents cold air and water drops from coming into your helmet.

### – RT-33 Ventilation system –

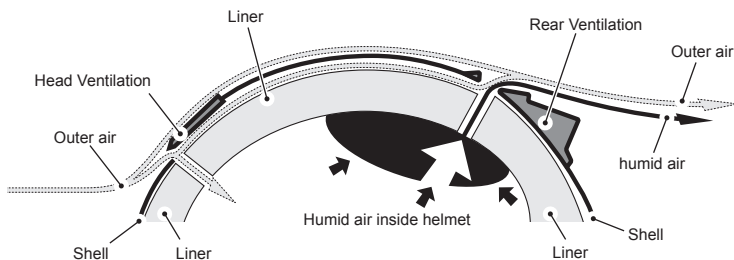

### Integrated Wake Stabilizer<sup>PATENTED</sup>:

The Wake Stabilizer<sup>PATENTED</sup>, Kabuto's unique system, is developed by analyzing the results of wind tunnel experiments at several angles. This unique system controls the airflow around the helmet and reduces loads while riding.

## 5 Open/Close Head Ventilation and Rear Ventilation

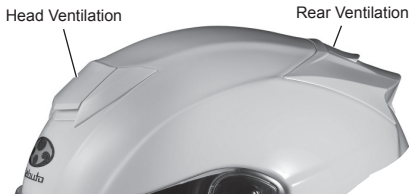

### – Open/Close Head Ventilation –

#### To Open

Slide the shutter backwards to introduce air from the outside.

#### To Close

Slide the shutter forwards to shut off air from the outside.

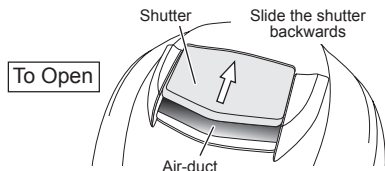

#### To Close

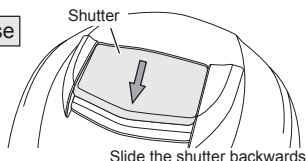

### – Open/Close Rear Ventilation –

#### To Open

Slide the shutter backwards to discharge the inside humid air forcibly.

#### To Close

Slide the shutter forwards to stop forcing out the inside stuffy air.

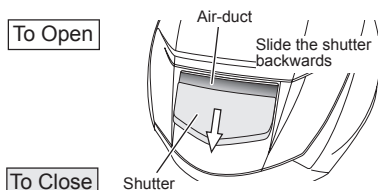

#### To Close

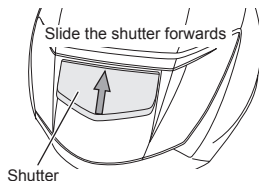

### ! CAUTION!

Do not put strong pressure on the ventilations.  
Make sure to treat them with care.

Please read the “WARNING” on the next page.

## ⚠ WARNING!

- Operating the shutter while riding is very dangerous. Never operate the shutter while riding. Operate it before riding.
- The air-ducts (air intakes and discharge holes) of the ventilations are designed in the proper sizes and quantities considered a large impact in the event of accidents and falling down. Customizing by enlarging or making more air-ducts would reduce the safety performances significantly and can cause serious injuries in case of an accident. Never customize your helmet.

## 6 Single Action Shield System PATENTED

The “Single Action Shield System PATENTED” is the shield replacement system developed by Kabuto. The system allows quick shield replacement for riding and racing conditions and easy maintenance.

### – How to remove the shield –

1. Move the shield up (Fig.1). (Move it up as far as it goes.)
  2. As shown in Fig. 2, pull the shield in the direction of the arrow while pressing down the release button on the shield. One side of the shield is completely removed.
- \*The shield can be removed easily by pulling it along the angle of the end of release button.
3. Repeat the same procedure for removing the other side of the shield. Then the entire shield can be completely removed.

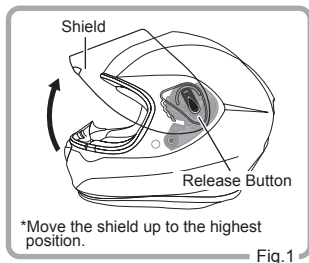

## ⚠ CAUTION!

- The shield is so constructed that it cannot be removed unless it is moved up to the highest position.
- Do not pull or twist the shield by force to remove it. Such action may damage the shield and ratchet system.
- Handle the removed shield with care in order not to damage it.

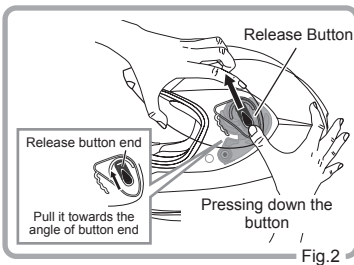

## - How to attach the shield -

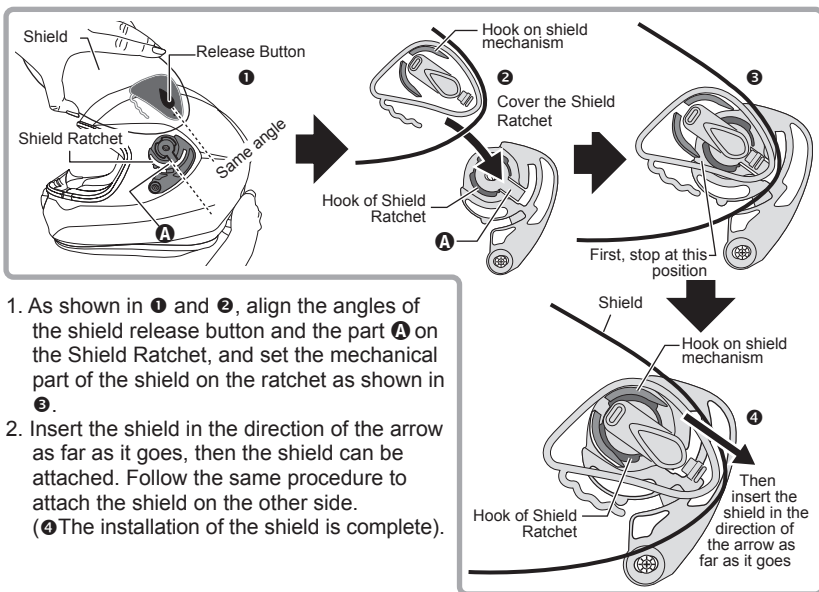

1. As shown in ① and ②, align the angles of the shield release button and the part A on the Shield Ratchet, and set the mechanical part of the shield on the ratchet as shown in ③.
2. Insert the shield in the direction of the arrow as far as it goes, then the shield can be attached. Follow the same procedure to attach the shield on the other side. (④ The installation of the shield is complete).

### ! CAUTION!

- Do not push or twist the shield by force when installing it. Such action may damage the shield and ratchet system.
- After installation, be sure to pull it lightly towards the removing direction to make sure that it is securely installed.
- After the installation of the shield is completed, open and close the shield three to four times to make sure that the shield works properly.

### ! WARNING!

- After the installation of the shield has been done, make sure that the shield is securely installed and that it is properly opened and closed before riding. If the shield does not work properly, or is installed insecurely, it may cause a failure in opening and closing the shield or lead to the removal of the shield while riding, thereby causing a great risk. If the opening and closing operations are not properly performed or abnormal noise is heard during these operations, check the steps in the installation procedure and repeat the installation procedure from the start.
- The shield is a consumable item. If the shield surface is damaged by a bug, stone, etc., it may hinder the vision, thereby causing a great risk. If the shield gets extremely dirty or scratched, replace it with a new one.

## 7 Remove/Replace of shield Ratchets

The "Shield Ratchet" is a part to control the open/close the shield and the function of the "Single Action Shield System PATENTED".

When the shield is completely removed in the procedure mentioned in **6** "Single Action Shield System PATENTED", the Shield Ratchet appears.

### – How to remove the Shield Ratchet –

Turn the Shield Ratchet Screws on the Shield Ratchet counterclockwise using a proper sized screwdriver until the screws are removed. Then, the shield ratchet can be removed. Follow the same procedure to remove the Shield Ratchet on the other side.

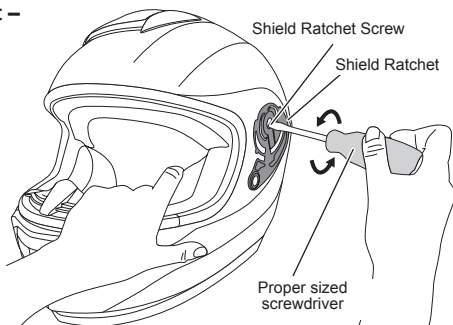

### ! CAUTION!

- Use the proper sized screwdriver to remove the Shield Ratchet Screws. Turn the screw by applying the screwdriver vertically to the screw. If the improper sized screwdriver is used or the screw is turned diagonally, the threads may be stripped.
- Do not lose the removed screws.

### – How to install the Shield Ratchet –

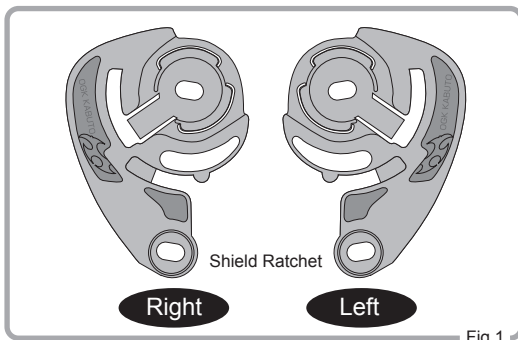

1. First, check the side of the Shield Ratchet as shown in Fig.1.

Fig.1

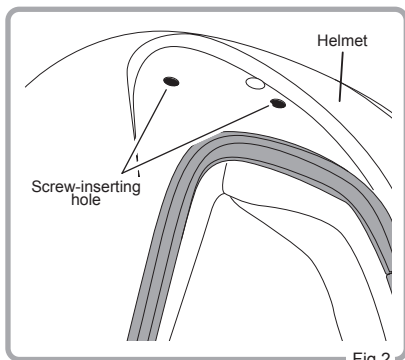

Fig.2

2. Place the Shield Ratchet in the hollow space on the side of the helmet and align the mounting holes on the shield ratchet with the mounting holes on the helmet (Fig. 2).

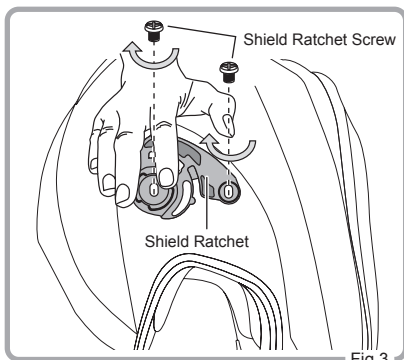

Fig.3

3. Fasten both Shield Ratchet Screws clockwise securely. Repeat the same procedure on the other Shield Ratchet. Then the Shield Ratchets are installed (Fig. 3).

### ⚠ CAUTION!

- Do not fasten the Shield Ratchet Screws too tight. Too much tightening of the screws may damage screws and other parts.
- Fasten the Shield Ratchet Screws by applying the screwdriver vertically to the screws. If the screws are fastened by applying a screwdriver diagonally, the threads may be stripped.

### ⚠ WARNING!

- The Shield Ratchet is an important part for open/close the shield. Install the Shield Ratchet securely. After the installation is completed, check to see that the shield can be closed to the lowest position and opened and closed correctly.
- Check and fasten the Shield Ratchet Screws regularly. Riding with the loosened Shield Ratchet Screws is very dangerous as the shield may be removed while riding.

## 8 Shield Post-3

RT-33 adopts the shield with Shield Post-3 which enables to use both Pinlock® Original Insert Lens inside and Replace Shield-3 on outside.

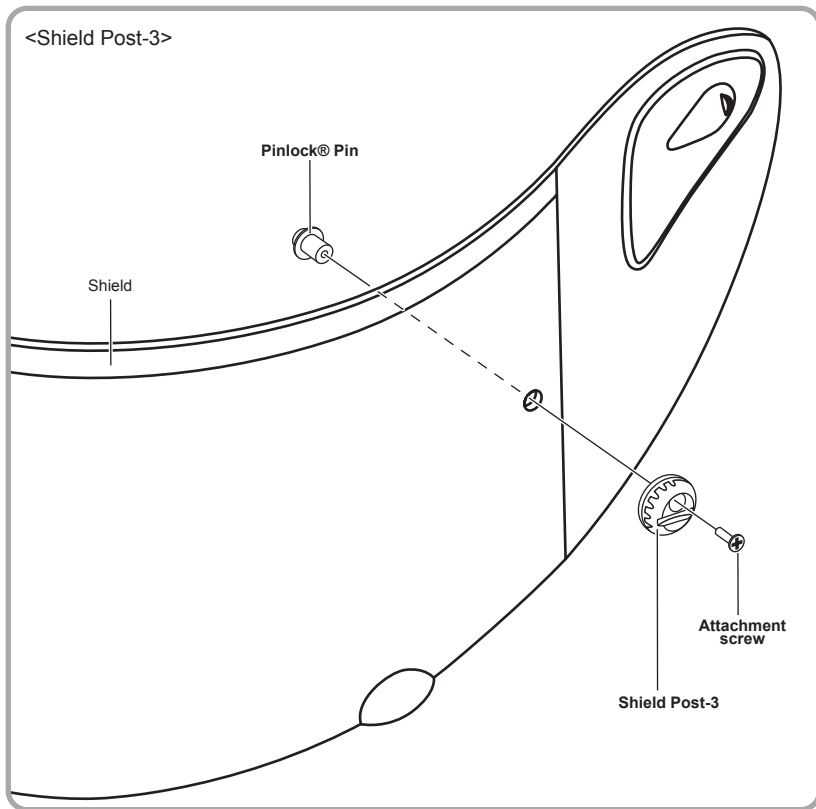

- Please read “ **9 Pinlock® Original Insert Lens**” for attaching Pinlock® Original Insert Lens.
- Please read “ **10 Replace Shield-3**” for attaching Replace Shield-3.

## 9 Pinlock® Original Insert Lens

**PINLOCK®**  
Original Insert Lens

Pinlock® Original Insert Lens has international patent protection and is a registered brand name of Pinlock systems B.V. Further patents have been applied for.

### [Pinlock® Original Insert Lens]

Pinlock® Original Insert Lens prevents the shield from fogging caused by thermal changes in winter or rainy weather etc.

Maintaining the proper space between the shield and the Pinlock® Original Insert Lens provides clear vision by balancing the inner and outer temperature.

### [How to Fit the Pinlock® Original Insert Lens]

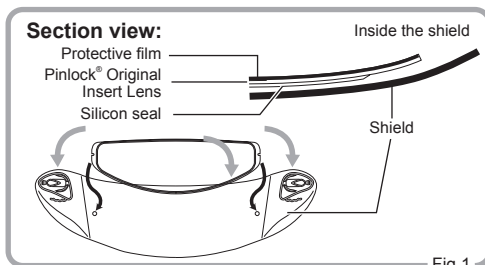

Fig.1

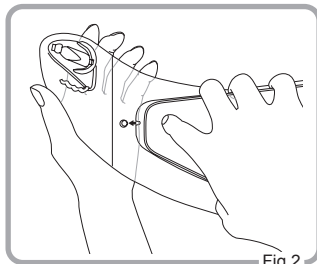

Fig.2

1. Apply the silicon seal side of the Pinlock® Original Insert Lens on inside the shield, without peeling off the protective film on the lens. At the time, apply the Pinlock® Original Insert Lens on inside the shield by clicking it into the eccentric pins. (Fig 1 and 2)

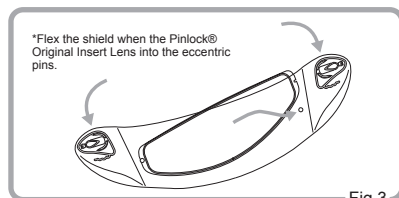

Fig.3

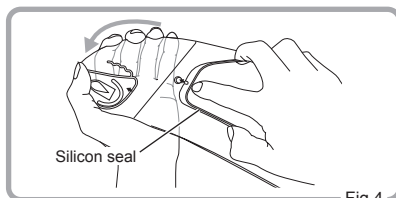
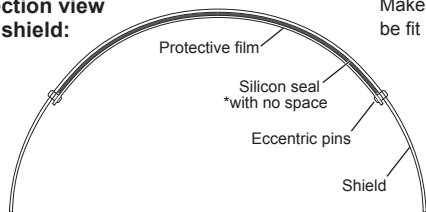

Fig.4

2. Flex the shield carefully until the shield becomes flat. Then, click the other side of the Pinlock® Original Insert Lens into the eccentric pins and then allow the shield to return carefully to its original curved shape. Make sure the Pinlock® Original Insert Lens to be fit inside the chase (Fig. 3,4 and 5). (Follow 3 on next page)



**Section view of shield:**

Make sure the Pinlock® Original Insert Lens to be fit inside the chase.

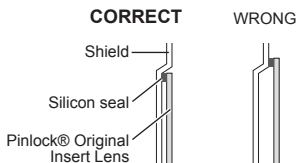

Fig.5

3. Make sure if the overall silicon seal of the Pinlock® Original Insert Lens is attached firmly to the shield by mounting the shield on the helmet. If there is any space between them, refer to “How to Adjust Pinlock® Original Insert Lens after Attachment” and adjust the lens.

\*Please mount the shield on the helmet when checking if the Pinlock® Original Insert Lens is attached firmly to the shield. Otherwise, the shield might be spread out by the pressure from the lens and it cannot be assured if the lens has attached on the shield firmly.

4. Peel off the protective film on the Pinlock® Original Insert Lens.

**[How to Remove Pinlock® Original Insert Lens]**

1. Remove the shield from the helmet.
2. Remove the Pinlock® Original Insert Lens from the eccentric pins with flexing the shield. (Fig.6)

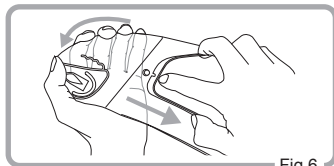

Fig.6

**[How to Adjust Pinlock® Original Insert Lens after Attachment]**

Adjust the Pinlock® Original Insert Lens if there is any space between the lens and the shield.

1. Remove the shield from the helmet and detach the Pinlock® Original Insert lens from the shield.
2. Adjust the eccentric pins by turning them with a tool. (Fig. 7)
3. Fit the Pinlock® Original Insert Lens back on the shield. Make sure the Pinlock® Original Insert Lens and the shield do not have any space in-between after attaching the shield on the helmet. If there is any space please follow the same steps again.

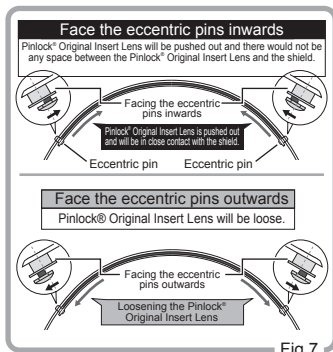

Fig.7

\* Please read carefully the “CAUTION” and the “CAUTION \*Pinlock® Original Insert Lens”.

**! CAUTION!**

- Flex the shield properly when fitting the Pinlock® Original Insert Lens. Otherwise, eccentric pins may be damaged.
- Clean the inside of the shield before applying the Pinlock® Original Insert Lens. Pay attention not to touch the anti-fogging part of the silicon seal on the Pinlock® Original Insert Lens.
- Do not use any petroleum products, thinner, glass cleaner, etc. It will degrade the material of the Pinlock® Original Insert Lens.
- Do not leave the Pinlock® Original Insert Lens where the temperature may surpass 50°C or near a heater, neither use a drier nor fire for drying. Heat may degrade the material of the Pinlock® Original Insert Lens.

**! CAUTION \*Pinlock® Original Insert Lens**

- Pinlock® Original Insert Lens is only for exclusive visors.
- If rain or water drops come in the space between the Pinlock® Original Insert Lens and the shield, please detach the Pinlock® Original Insert Lens from the shield and dry them out. Then, reattach the Pinlock® Original Insert Lens on the shield.
- Please remove the Pinlock® Original Insert Lens at times for maintenance. Otherwise the silicon seal of the lens would adhere to the shield.
- Do not use any shields or pins other than exclusive ones for the Pinlock® Original Insert Lens.
- Please be informed that if you are riding with the ventilations closed or using the Wind Shutter, may cause the Pinlock® Original Insert Lens to become fogged.
- Please replace Pinlock® Original Insert Lens if the anti-fog performance decreases and/or being scratched.
- Silicon seal may come into view depending on the riding position.

## 10 Replace Shield-3 (Optional Parts)

RT-33 adopts Shield Post-3 which enables you to use a disposable tear-off film "Replace Shield-3"(Optional Parts), useful on racing and touring. This Shield Post-3 is eccentric, the axis of which is not in the center, and by turning this Shield Post-3, the Replace Shield-3 will be in close contact to a shield.

Before attaching the Replace Shield-3, loosen a Shield Post-3. After attached the Replace Shield-3, tighten the attachment screw properly\*.

\*"Properly" is about the tightness you cannot rotate the post with your finger but with a coin.

### – How to Attach Replace Shield-3 –

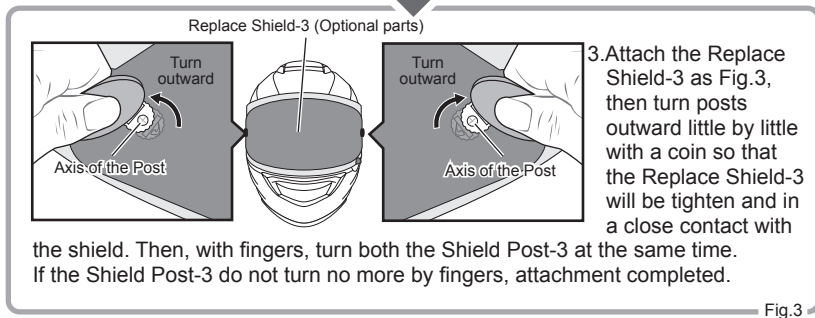
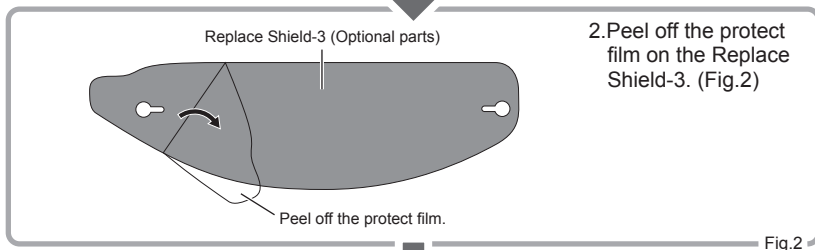
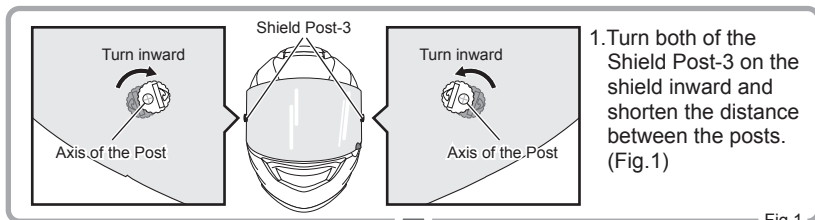

\*Please read Caution and Warning on the next page.

**! CAUTION!**

By colours on the Replace Shield-3, interference colours might be visible when in close contact with a shield. If this causes uncomfortable vision, try other colours or stop using the Replace Shield-3.

**! WARNING!**

- Peel off the protect film on the Replace Shield-3 before use. Using with leaving the protect film on the Replace Shield-3 reduces your visibility and it is very dangerous.
- Make sure the Replace Shield-3 is in close contact with the shield by checking turning the posts by finger and confirm the post does not turn. Using the Replace Shield-3 with a loose fit on the shield is very dangerous. It will make the Replace Shield-3 moves on the shield by wind pressure, and causes to reduce visibility and to scratch the shield.
- Do not use the Replace Shield-3 in the rain. It will cause the rain drop coming in between the Replace Shield-3 and the shield, and reduces visibility. It is very dangerous.
- Do not use the Replace Shield-3 once adhered the insects, sand, dust and etc. Replace with a new Replace Shield-3.

**IMPORTANT To Avoid Pinlock® Pin from Turning Together With Shield Post-3**

When attaching Replace Shield-3, you might find the Shield Post-3 and Pinlock® pin turns at a time.

In that case, to turn them discretely, use 5mm tool to hold the Pinlock® pin and turn the attachment screw to tighten properly\*.

\*Please refer **10** Replace Shield-3 to adjust the Replace Shield-3 tightness.

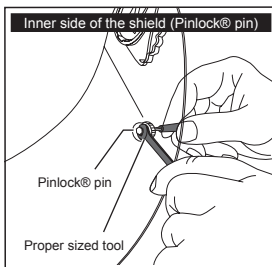
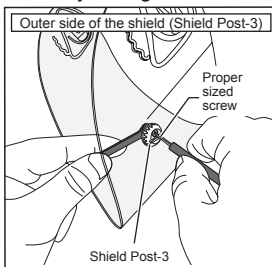
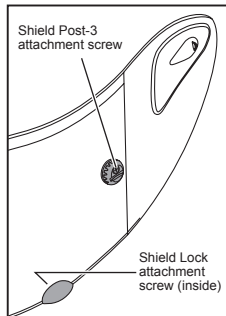
**Make sure to check up and maintain the attachment screws periodically.**

Attachment screws on Shield Post-3 and Shield Lock may be loose in use by vibration of riding motorcycle. Using with loosen screw is dangerous as those parts will be falling off or flying apart. Please make sure to check up and maintain the attachment screws to be tighten periodically.

**! CAUTION!**

Do not tighten the screw forcibly.  
It will break the parts and shield.

## 11 Remove/Replace Cheek Pads

### – How to remove the cheek pads –

Remove the cheek pad from hook and loop fastener and the snaps by gripping it firmly then pull it out. (Fig.1)

### ! CAUTION!

When removing the cheek pad, be sure to grip the base of cheek pad where the hook and loop fastener and the snaps are attached. Otherwise, the cheek pad may be damaged.

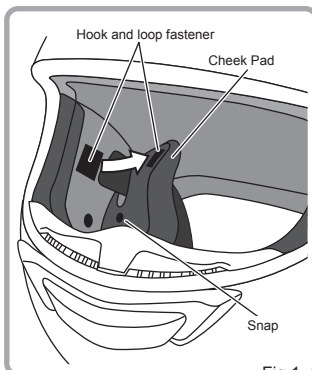

Fig.1

### – Attachment of Cheek pads – (Fig.2)

1. Check the side of the cheek pad.
2. Insert the interlining in-between the shell and the liner, then place the chinstrap as shown.
3. Fasten securely the hook and loop fastener and 2 snaps on the back of the cheek pad. Follow the same steps on the other side.

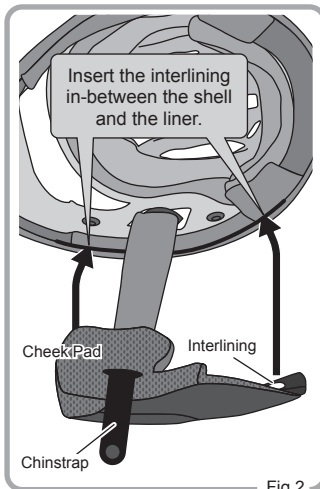
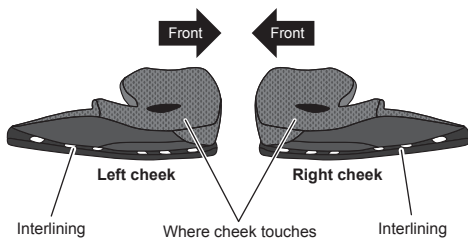

Fig.2

### ! CAUTION!

Be sure that the cheek pads are attached on the helmet securely before riding. It is hazardous to use this helmet without cheek pads or attaching the cheek pads improperly.

## 12 Remove/Replace Inner pad

### – How to remove the inner pad –

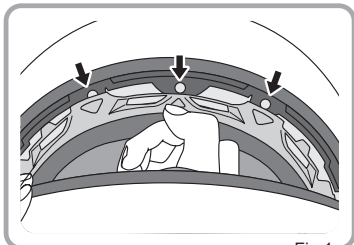

Fig.1

- 1.Undo the snaps at the forehead area by pulling them down as shown in Fig.1.

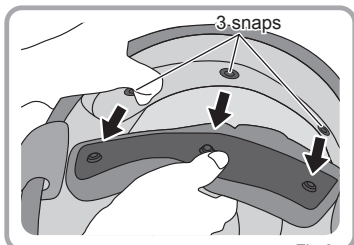

Fig.2

- 2.Undo the 3 snaps at the rear, then the inner pad can be removed. (Fig.2)

### – How to attach the inner pad –

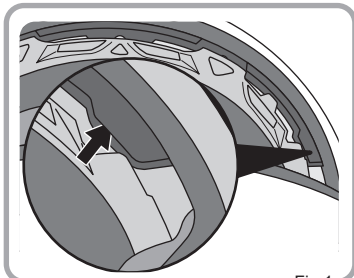

Fig.1

- 1.Insert the interlining at the temple areas as shown in Fig.1.

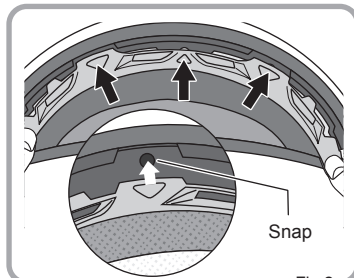

Fig.2

- 2.Insert the 3 snaps on the front as shown in Fig.2.

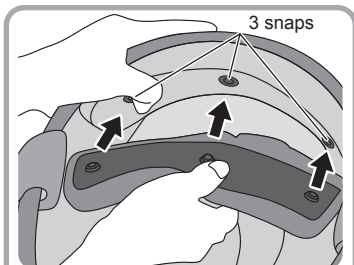

Fig.3

- 3.Fasten the 3 snaps at the rear to complete attaching the pad.

### ! CAUTION!

- Pull the snaps gently to remove the inner pad. Otherwise the material and parts may be damaged.
- If the inner pad is not securely installed, the helmet may be unstable while riding, thereby causing a great risk. Fasten the snaps properly.

## NOTE

**Exchangeable Inner Pad, Cheek Pads and Chinstrap covers**

RT-33 interiors are exchangeable as shown in the table below. Fine fitting can be achieved by changing only cheek pads etc.

**RT-33 Inner pad**

	Shell size	Pad size (Thickness)	Exchangeable	Included in package	
	<b>M</b>		XS (19mm)	Interchangeable among the sizes of XS, S and M	Inner pad x 1pce
			S (15mm)		
			M (9mm)		
<b>L</b>		L (12mm) XL (9mm)	Interchangeable between the sizes of L and XL	Inner pad x 1pce	
<b>XXL</b>		XXL ( ) XXXL ( )	Interchangeable between the sizes of XXL and XXXL	Inner pad x 1pce	

**RT-33 Cheek pads**

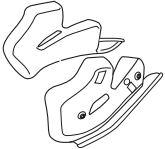
	Shell size	Pad size (Thickness)	Exchangeable	Included in package	
	<b>M</b>		XS (35mm)	Exchangeable among all sizes	Cheek pad x 1set (right and left)
			S (31mm)		
			M (24mm)		
<b>L</b>		L (26mm) XL (20mm)			
<b>XXL</b>		XXL ( ) XXXL ( )			

**RT-33 Chinstrap cover**

	Exchangeable	Included in package
	Exchangeable among all sizes	Chin strap cover x 1set (right and left)

**IMPORTANT****Cleaning of Inner Pad, Cheek Pads and Chinstrap covers**

- The interiors of this helmet are washable by a washing machine. Put each pad in a washing net and wash them separately.
- Use detergent in cold or warm water for cleaning. Never use hot water, chemical detergents, and organic solvents for cleaning the pads. The use of these agents may degrade the quality and damage the pads.
- Even commercially-available detergent may cause a little discolouration of the pad depending on the type of detergent. Thus, please wash each pad separately as much as practical.
- If the pad is washed in a washing machine with a drying function in which the temperature is increased to 50°C or more, it may cause deterioration in quality and damage of the pads. Do not use such a device for cleaning of the pad.
- Drain a pad after washing and dry the pad in shade so that it is not exposed to direct sunlight. After making sure that it is dried enough, attach it on the helmet.
- The inner pad and the cheek pad are consumable items. Even under normal usage, the fabric material and inner foam may be worn and deteriorated depending on the frequency of usage. Please replace the pads with new ones as appropriate.

## 13 Remove/Replace Wind Shutter-2

The Wind Shutter-2 is included in the package as the standard accessory. This accessory is intended to reduce the introduction of wind from chin area while riding. It can be attached and detached as desired according to seasons and intended applications.

### – How to install Wind Shutter-2 –

1. Refer to Fig.1 and check the front side and back side of the Wind Shutter-2.

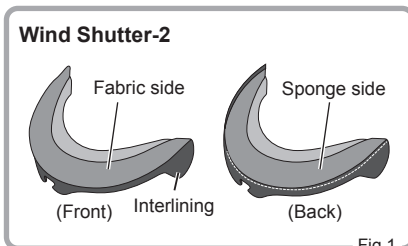

Fig.1

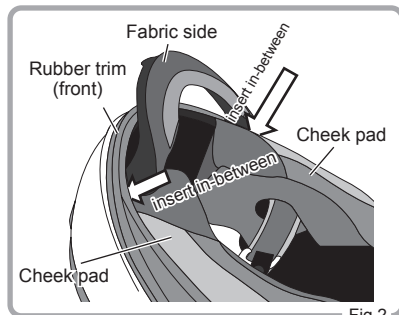

Fig.2

2. As shown in Fig.2, turn the helmet over and attach the Wind Shutter-2 on the front (chin area) of the helmet. IN doing this, insert the interlining of both sides of the Wind Shutter-2 in-between the front area of the cheek pad and the rubber trim.

3. As shown in Fig.3, insert the interlining of the Wind Shutter-2 uniformly into the inside of the rubber trim from both sides towards the center.

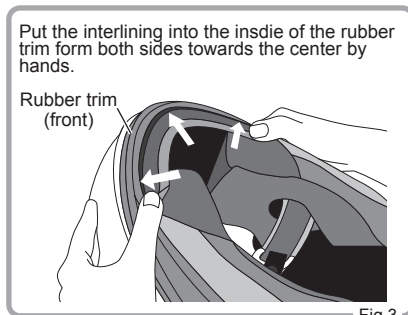

Fig.3

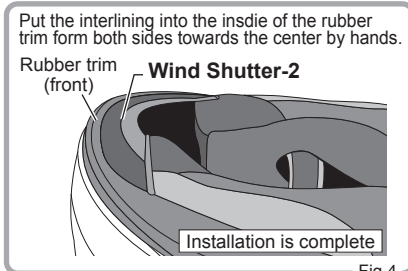

Fig.4

### ! CAUTION!

- Install the Wind Shutter-2 securely. Insecure installation may cause falling of the Wind Shutter-2 while riding.
- Do not use an adhesive agent or similar items but install the Wind Shutter-2 according to the procedure given above. Some components of an adhesive agent may damage the material of the helmet.

4. Put the interlining so such extent that the edge of the frame rubber is almost flat with the Wind Shutter-2. The attachment of the Wind Shutter-2 is complete (Fig.4).



### – How to remove Wind Shutter-2 –

Firmly hold the interlining area around the center of the Wind Shutter-2 and pull it up. Then the Wind Shutter-2 will be removed.

#### ! CAUTION!

To remove the Wind Shutter-2, gently pull up and take off carefully. Otherwise the cloth and/or a part may be damaged.

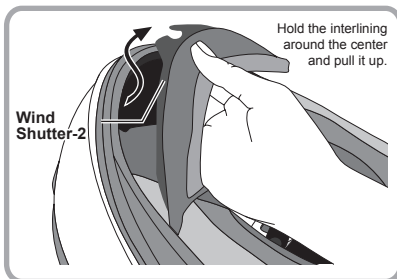

## 14 Remove/Replace Breath Guard-5

The Breath Guard-5 may be detached or attached according to your needs.

### – Detaching –

Grip the Breath Guard-5 securely, and pull it out to remove it.

### – Attaching –

As shown in the figure, set the center of the Breath Guard-5 onto the center of the helmet, and push in the Breath Guard between the shield rubber trim and the chin liner.

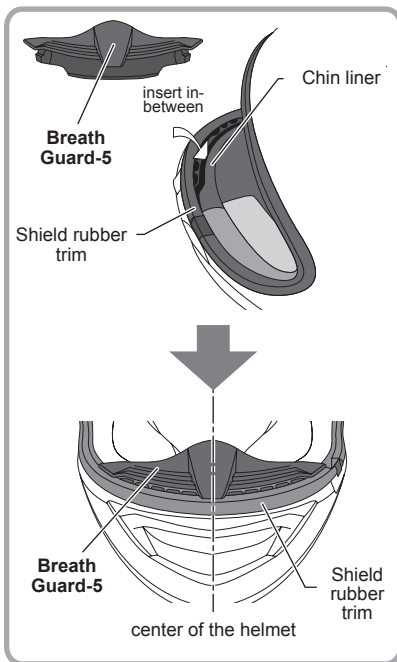

#### ! CAUTION!

Do not use an adhesive agent but follow the procedure given above to attach the Breath Guard-5. Some components of an adhesive agent may damage the material of the helmet.

The logo for COOLMAX is presented in a stylized, rounded rectangular frame with a metallic or gradient effect. The text "COOLMAX" is written in a bold, sans-serif font, with a registered trademark symbol (®) to the upper right of the word.

**COOLMAX® is used for the interior fabrics so as to allow quick evaporation of sweat and brings cool and comfortable use.**

**– Evaporate sweat quickly to achieve cool and comfortable use –**

•When sweat comes out from the body, COOLMAX® allows discharging moisture to the outside and takes in air from the outside to cool and dry your body. As a result, the temperature on the body surface is lowered and exercise great moist adjustment accordingly.

•COOLMAX® provides a natural touch to the texture with soft and light weight and good permeability properties.

\*COOLMAX® is the registered trade name of INVISTA.

### **Contact for inquiries on the products and request for repair:**

Contact an authorized dealer of Kabuto helmets about the products and request for repair.

### **Parts that cannot be repaired:**

The following parts cannot be repaired in terms of assuring the performance of the helmet.

- Helmet body (Shell)
- Shock absorbing liner (Main body, chin area )
- Chinstraps including D rings

Contact authorized Kabuto dealers for detailed information on repair and others.

# RT-33 Parts List and Table for Replacement

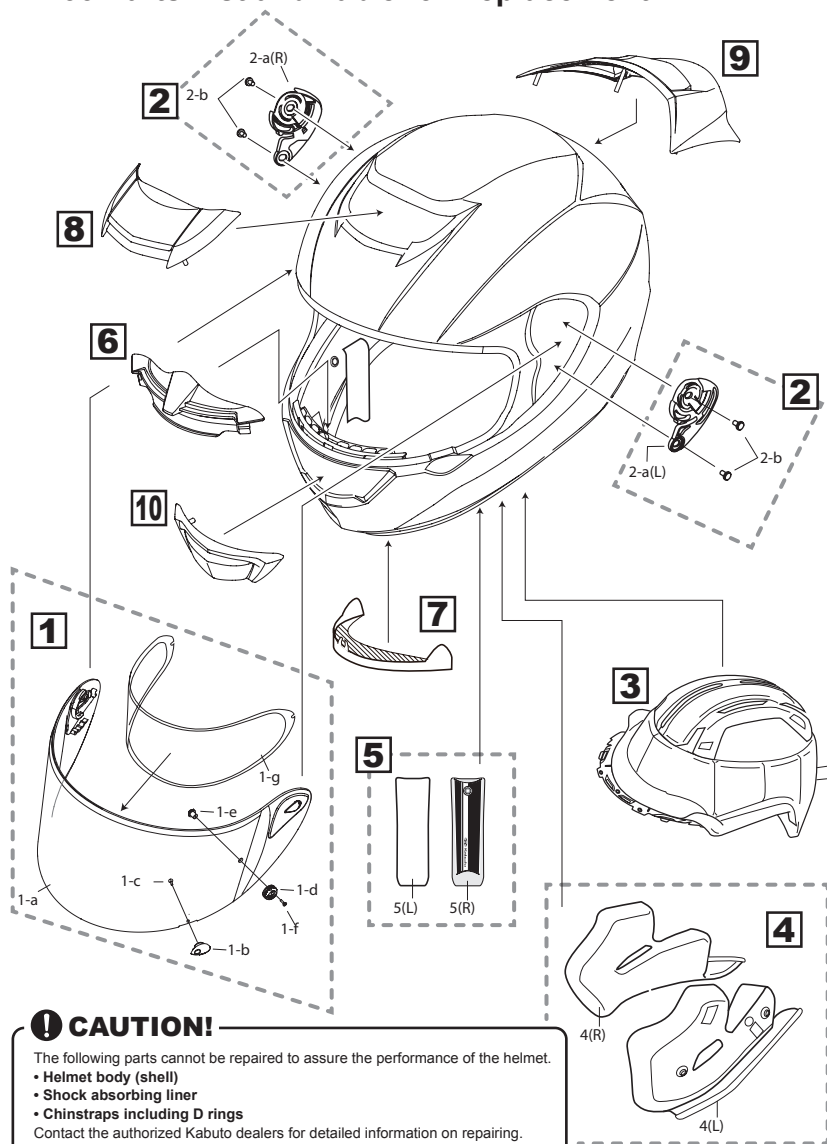

# RT-33 Parts List and Table for Replacement

No.	Parts	Contains
<b>1</b>	SAF-W shield	1-a: SAF-W Shield (standard: clear ) x 1
		1-b: Shield lever x 1
		1-c: 2.3x6 B-O screw x 1
		1-d: Shield Post-3 x 2
		1-e: Pinlock® pin-2 x2
		1-f: attachment screw x 2
	Shield Post-3 set	1-d: Shield Post-3 x 2 1-e: Pinlock® pin-2 x2 1-f: attachment screw x 2
	SAF-W Pinlock® Original Insert Lens	1-g: SAF-W Pinlock® Original Insert Lens x 1
<b>2</b>	SAF Shield Ratchet set	2-a: SAF ratchets (R/L) x 1 2-b: 7L-B screw x 4
	SAF Shield Ratchet screw set	2-b: 7L-B screw x 4
<b>3</b>	RT-33 Inner pad	3: *see page 21 (XS,S,M,L,XL,XXL,XXXL) Inner pad x 1
<b>4</b>	RT-33 Cheek pad set	4: *see page 21 (XS,S,M,L,XL,XXL,XXXL) Cheek pads (R/L) x 1
<b>5</b>	Chinstrap cover	5: Chinstrap cover (R/L) x 1
<b>6</b>	Breath Guard-5	6: Breath Guard-5 x 1
<b>7</b>	Wind Shutter-2	7: Wind Shutter-2 x 1
<b>8</b>	RT-33 Head Ventilation	8: Head Ventilation x 1
<b>9</b>	RT-33 Rear Ventilation Fin	9: Rear Ventilation Fin x 1
<b>10</b>	RT-33 Chin Ventilation	10: Chin Ventilation x 1
<b>Optional Parts</b>	Replace Shield-3	Clear (3pcs)
	*Replace Shield-3 is exclusive to SAF-W shield. (not conforms to SAF shields.)	Smoke (2pcs)
		Silver Mirror (1pc)
		Blue Mirror (1pc)

\*The parts listed above are available from an authorized KABUTO dealer.

\*Parts with colour variations, specify your desired colour in placing an order.

\*The materials and specifications are subjected to change without notice for further improving the performance of the product.

\*Check out our website for details about the parts. <http://www.ogkkabuto.com>



**Kabuto**

Safety Meets Style

OGK KABUTO CO., LTD.

6-3-4, NAGATANISHI, HIGASHIOSAKA, OSAKA, 577-0016, JAPAN.

TEL:+81-6-6748-7806 FAX:+81-6-6747-8023

[www.ogkkabuto.com](http://www.ogkkabuto.com)